

Andrea

Assembly Instructions



Opening Box

Ensure that you **DO NOT** push your knife too far into the box when cutting it open.

Lift the cardboard with one hand while cutting, thereby keeping the blade well away from your furniture.

Assembling your furniture. Please follow the following 9 steps.

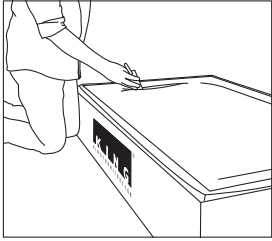

1

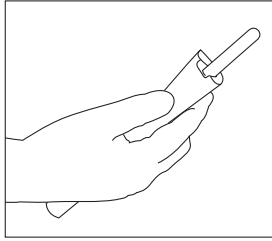

2

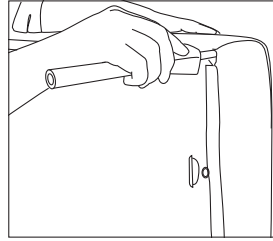

3

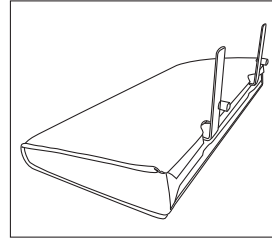

4

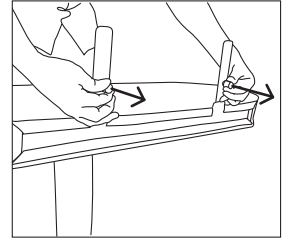

5

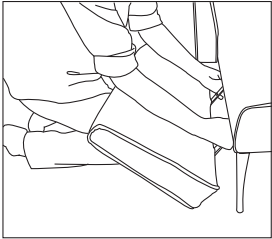

6

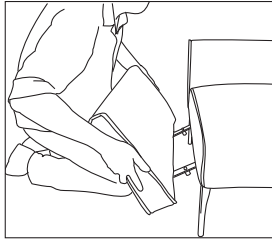

7

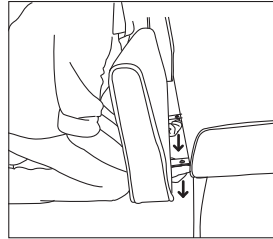

8

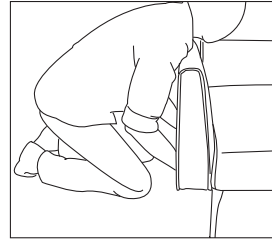

9

Adjustable Arm

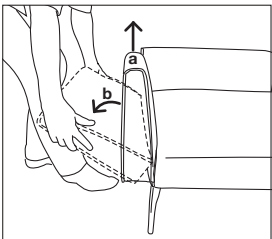

1